

Servicing Wavegrip Self-Tailing winches 55ST, 65ST.

7
No. 40ST, 42ST

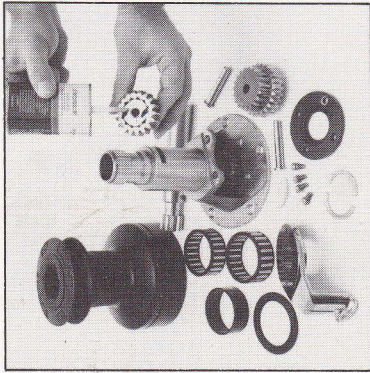

Remove pawl gears and clean. Lightly oil pawls and grease gears.

8
Nos. 44ST, 48ST

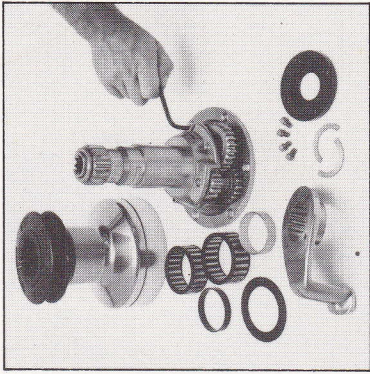

Remove socket head screws from centre stem, with a 3/4" A/F Allen key

9
Nos. 44ST, 48ST

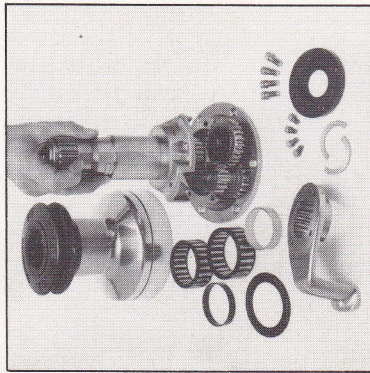

Remove top of centre stem complete with spindle.

10
Nos. 44ST, 48ST

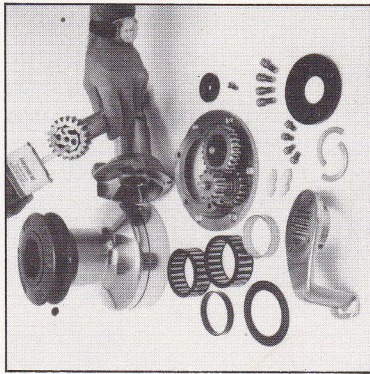

Remove spindle, lightly oil pawls and grease gear

11
Nos. 44ST, 48ST

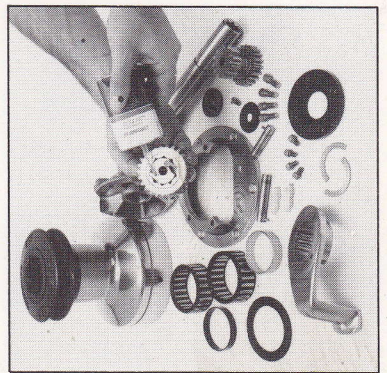

Remove pawl gears and clean. Lightly oil pawls and grease gears.

1

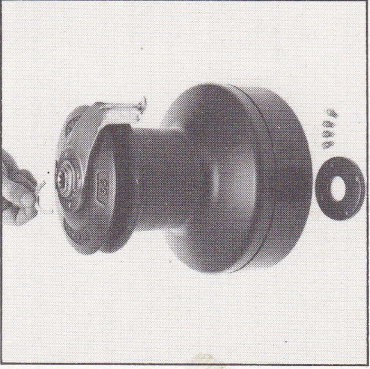

Remove the 4 x 1/4" UNC socket head screws and lift off top plate. Remove the two keys securing the stripper arm.

2

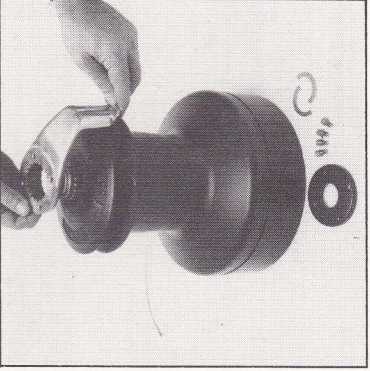

Lift off the stripper arm from its locating spline.

3

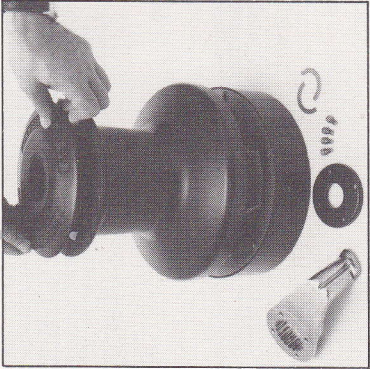

Lift off drum.

4

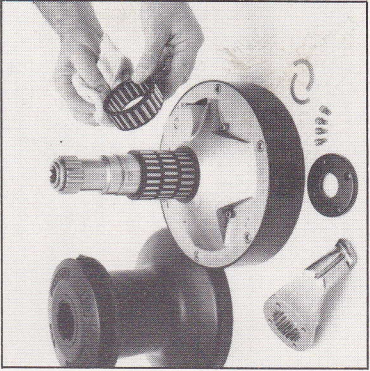

Clean centre stem, roller bearings, lower gears and drum bore with a non-fluffy cloth.

5

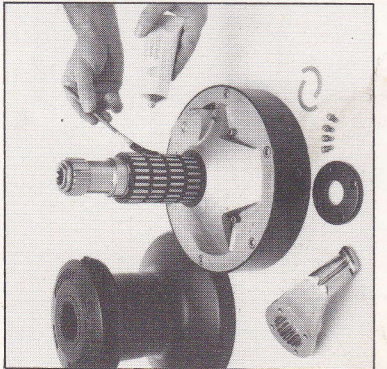

Lightly grease roller bearings, lower drum ring and gear teeth.

Reassemble winch in reverse sequence to above. Check for correct operation.

Reassemble winch in reverse sequence to above. Check for correct position.