

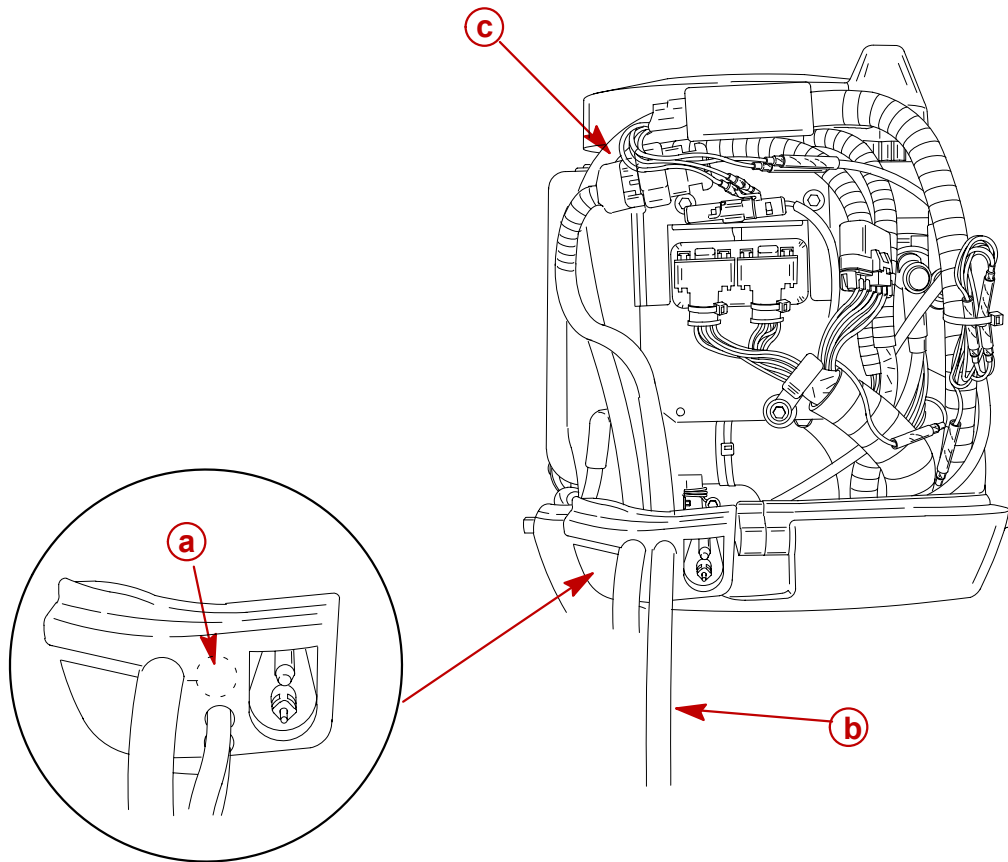

Wiring for SmartCraft Gauges – EFI Models

SmartCraft Wiring Harness Connection to the Engine

1. Cutout the harness opening in the front rubber grommet.
2. Route the SmartCraft wiring harness into the bottom cowl and connect as shown.



- a** - Front Rubber Grommet - Cutout Harness Opening
- b** - SmartCraft Harness
- c** - Connection for SmartCraft Harness



Typical SmartCraft Installation Configurations – EFI Models

Single Engine Applications

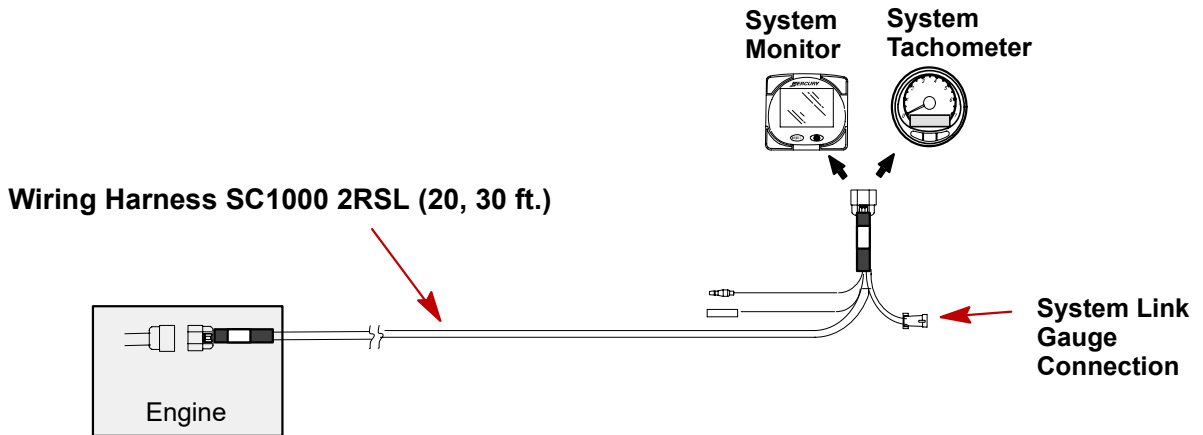

Dual Engine Applications

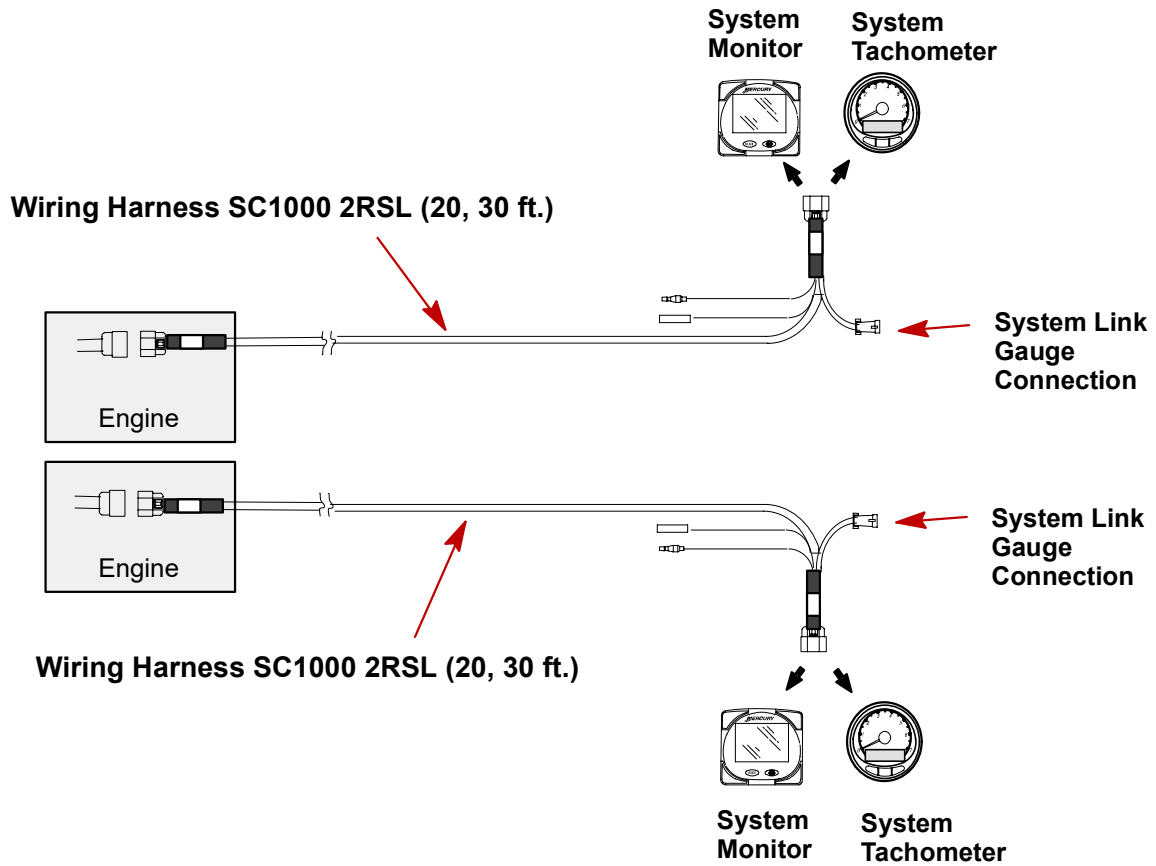



Notes:



Instrument/Lanyard Stop Switch Wiring Diagram (Dual Outboard)

- BLK = Black
- BLU = Blue
- BRN = Brown
- GRY = Gray
- GRN = Green
- ORN = Orange
- PNK = Pink
- PUR = Purple
- RED = Red
- TAN = Tan
- WHT = White
- YEL = Yellow
- LIT = Light
- DRK = Dark

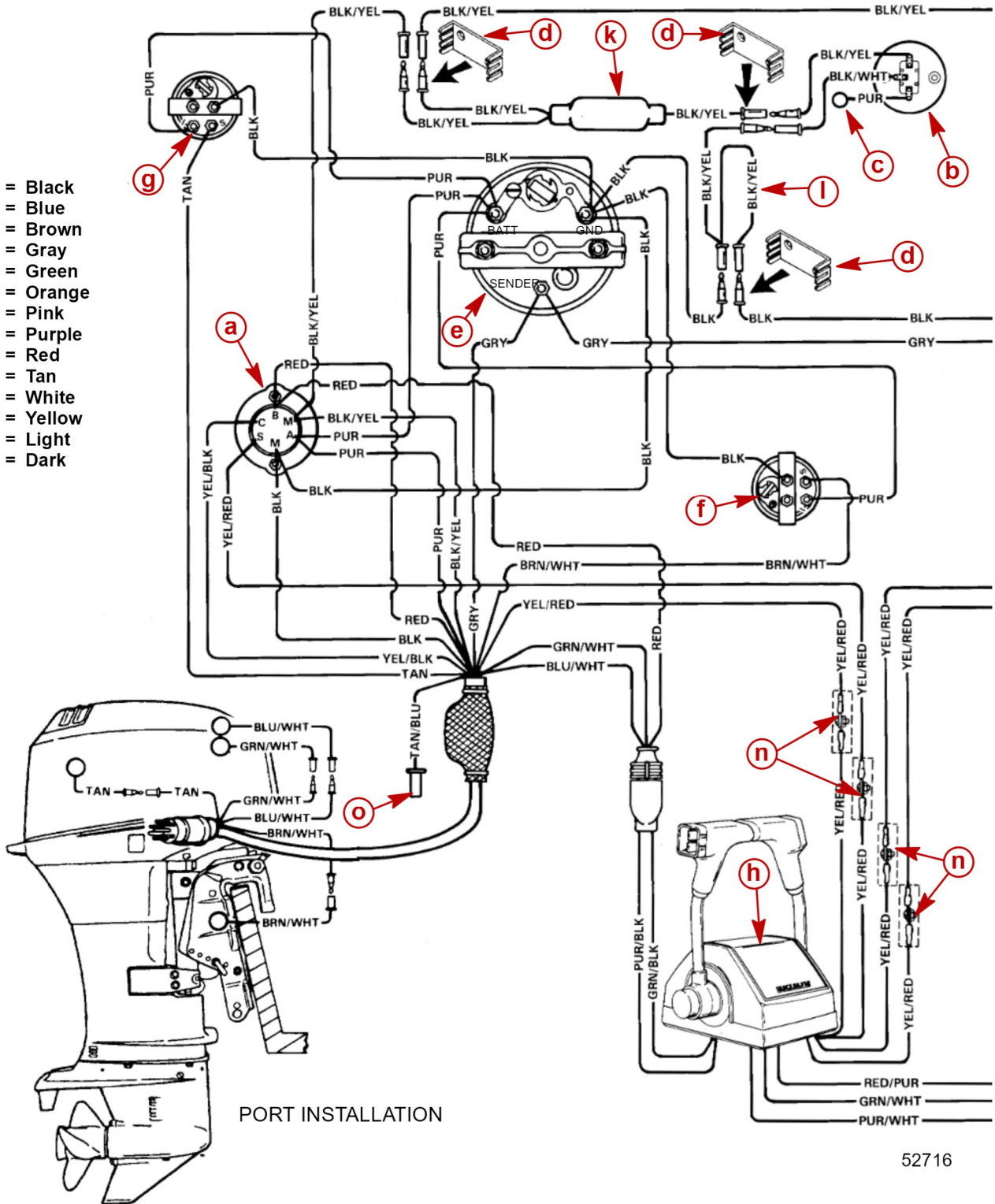

PORT INSTALLATION

52716

- a** - Ignition/Choke Switch
- b** - Lanyard Stop Switch
- c** - Lead Not Used on Outboard Installations
- d** - Retainer
- e** - Tachometer
- f** - Trim Indicator Gauge
- g** - Temperature Gauge
- h** - Remote Control
- i** - Synchronizer Gauge
- j** - Synchronizer Box



IMPORTANT: On installations where gauge options will not be used, tape back and isolate any unused wiring harness leads.

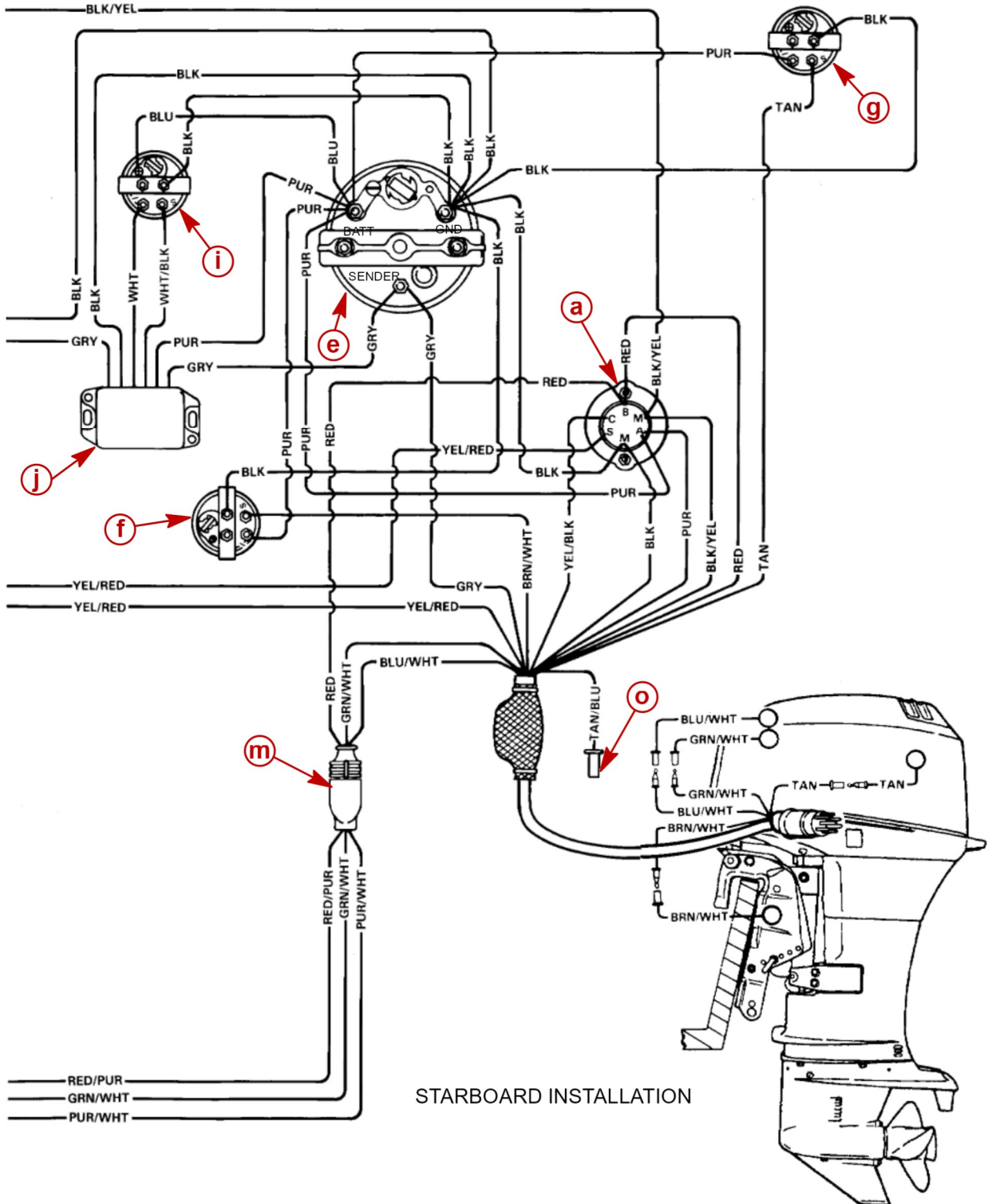

STARBOARD INSTALLATION

5265

- k** - Lanyard/Diode
- l** - "Y" Harness
- m** - Power Trim Harness Connector

- n** - Connect Wires Together with Screw and Hex Nut (4 Places); Apply Quicksilver Liquid Neoprene to Connections and Slide Rubber Sleeve over Each Connection.
- o** - Lead to Visual Warning Kit